

ABOUT

Our decorative WetArea Panels are specially designed for use in wet areas like Bathrooms, Laundries and Kitchens, but can be fixed anywhere in the house or office where temperatures do not exceed 60 degrees celsius. The panels are made of high grade PVC material in sheets of 2400 * 1000 mm and are 10 mm thick - so perfect to fit most rooms with each panel from floor to ceiling.

Our WetArea Panels:

- are 100% Waterproof and Mould Resistant
 - No grout means Easy to keep Clean
 - Very Quick Installation compared to alternatives like Tiles
- Can be fitted to almost any surface including over existing tiles, plaster boards, concrete walls, brick, etc
 - Choose from a beautifully decorated range of 16 colours in gloss or matt finish
 - 10 Years Replacement Warranty
- The watertight tongue and groove click system makes joining panels to one another super easy for an almost seamless finish. The corrugate extruded structure makes it light to work with, yet sturdy despite its size. The installation can be done as a DIY project or by most tradesmen. Only common tools needed.
- The lacquered (UV treated) surface of the panels enables the panels to be easily cleaned with a damp cloth.



Builders[™]
EXPRESS
KITCHENS & BATHROOMS
DIRECT TO THE PUBLIC



CONTACT US

Builders Express
2/36 Stoddart Rd, Prospect
NSW 2148

(02) 9636 8700

www.builderexpressnsw.com.au

**Our PVC WetArea Panels
are the best alternative
to tiles ... and now available
in 16 exciting colours**



WetArea Panels

GROUT FREE WALLS

DIY Installation or ask us for Tradesmen

ORDER ONLINE!



Mould
Resistant



100%
Waterproof



Grout FREE



Super Quick
Install



Easy
Clean

www.builderexpressnsw.com.au

COLOURS

WetArea Panels - Size: 2400*1000*10mm

\$209 per Panel



WetArea Panels - Size: 2700*1000*10mm **\$239**



INSTALLATION

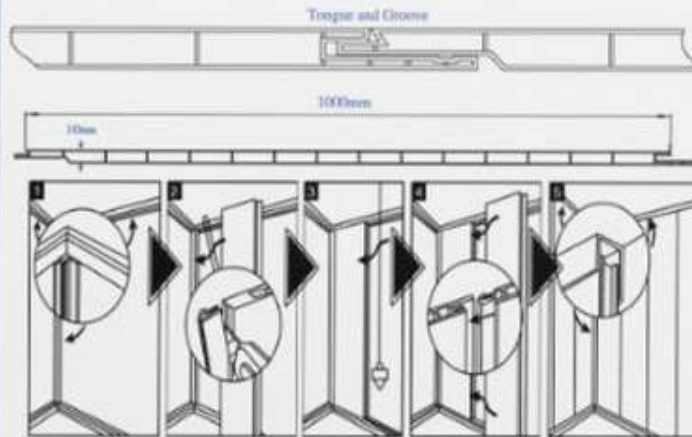

WetArea Panels feature a tongue and groove joint which provides a tight waterproof fit and an almost seamless joint between panels.

They could be easily glued onto the wall or simply over existing tiles.

Several YouTube Videos can be found on how to install Wet Wall Panels, for example:

<http://www.youtube.com/watch?v=CMc1h2C9RDM>

...and below videos with some useful tips and guidelines for a great installation:

<http://www.youtube.com/watch?v=JvhltznAkwU>

<http://www.youtube.com/watch?v=k3fezlgKKZ4>



TRIMS \$12 per Trim



Wet Wall Panel Internal Corner Trim 2400mm



Wet Wall Panel End Cap Trim 2400mm



Wet Wall Panel External Corner Trim 2400mm



Wet Wall Panel H Trim 2400mm



Trims available in White, Chrome, Grey and Black

ADHESIVE



Multi Bond Adhesive
15 to 2 tubes per Panel

\$12 each

Silicone available in:

- Brilliant White
- Light, Medium and Dark Grey
- Charcoal
- Black



All Purpose Silicone
0.5 tube per Panel

\$12 each